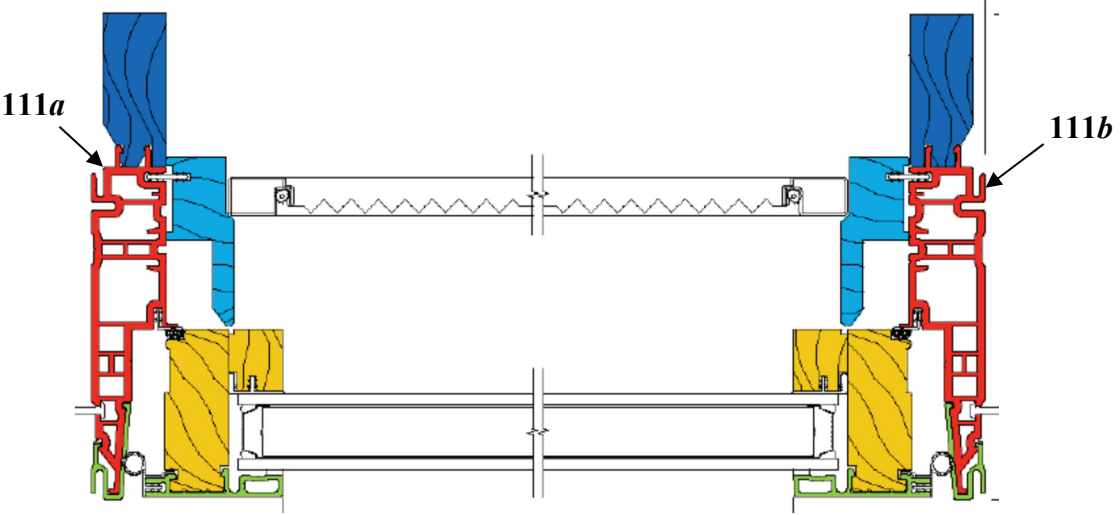
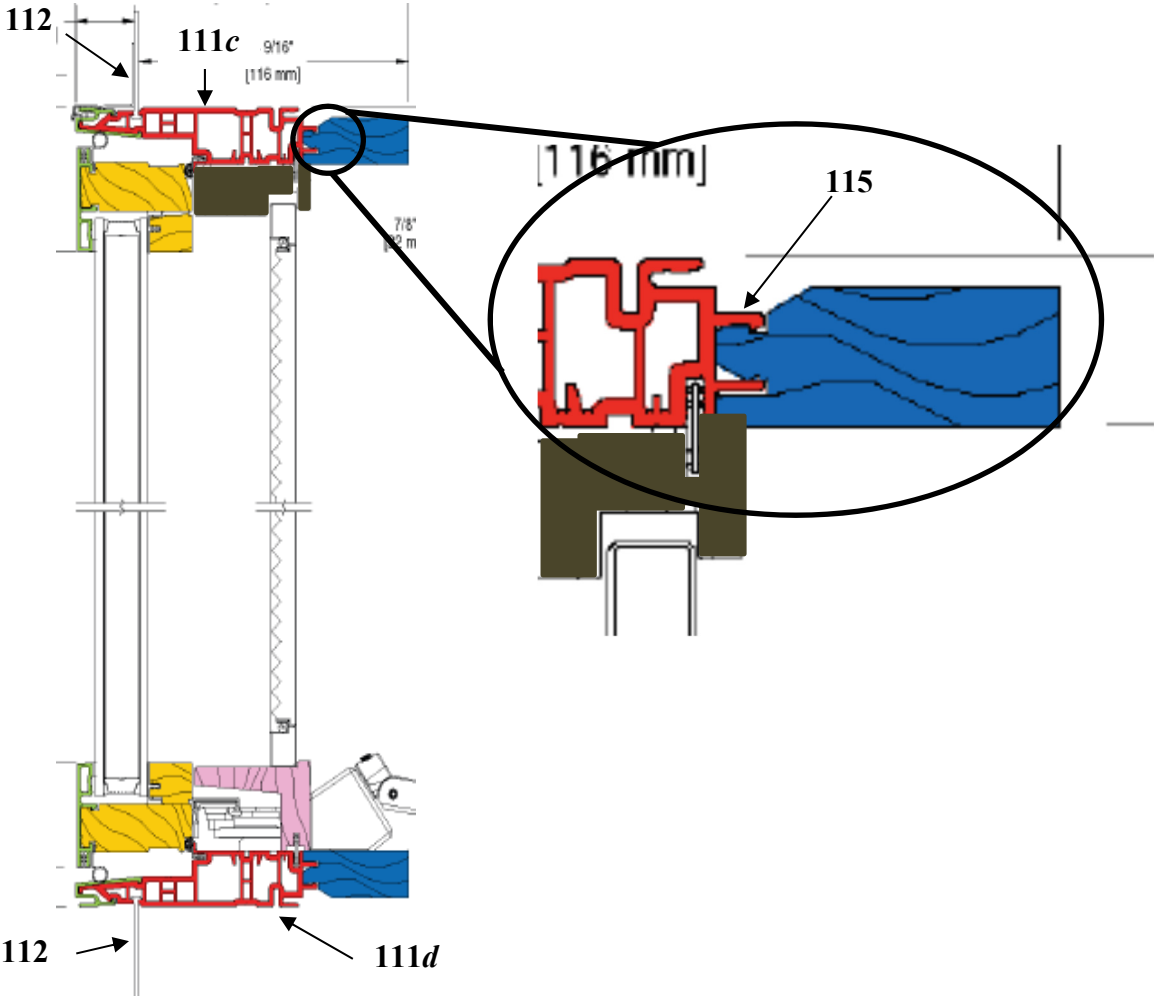
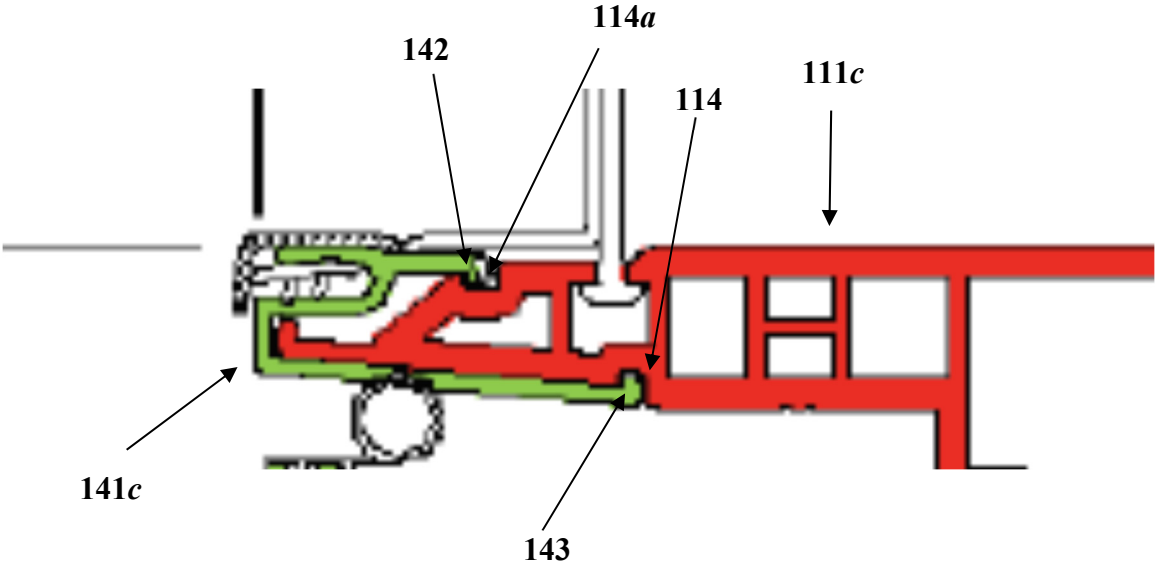

<b><u>'365 Patent Claim Element</u></b>	<b><u>VistaLuxe® Casement and Awning Products<sup>1,2</sup></u></b>
<p>1. A window assembly comprising:</p> <p>(a) a base frame assembly including a plurality of base frame members that form a frame, the base frame assembly being attachable to an opening in a wall and being constructed of a plastic type material, each base frame member having a pair of extension clips;</p>	<p>The VistaLuxe® Window Cross-Sections show a window assembly comprising a base frame assembly including a plurality of base frame members <b>111a</b>, <b>111b</b>, <b>111c</b>, <b>111d</b> that form a frame, the base frame assembly (shaded red) being attachable to an opening in a wall (for instance utilizing nail fin <b>112</b>) and being constructed of a plastic type material (extruded vinyl),</p> 

<sup>1</sup> The cross-sectional drawings depicted within the chart were obtained from the website of Petitioner, Kolbe & Kolbe Millwork Co. Inc., on or about December 11, 2019. These drawings were annotated with color but are otherwise unaltered. The full versions of the drawings annotated with color are appended to this document as Appendix A. The same or similar drawings can be found at <http://www.kolbewindows.com/resources/architect-library/>.

<sup>2</sup> Numerical references correspond with the numerical references found with the '365 Patent.

<p><b><u>'365 Patent Claim Element</u></b></p>	<p><b><u>VistaLuxe® Casement and Awning Products<sup>1,2</sup></u></b></p>
	<p>each base frame member having a pair of extension clips <b>115</b> (as highlighted in blow-up):</p> 

<p><b><u>'365 Patent Claim Element</u></b></p>	<p><b><u>VistaLuxe® Casement and Awning Products<sup>1,2</sup></u></b></p>
<p>(b) an external cladding assembly including a plurality of cladding members that form a frame, the external cladding assembly being connected to the base frame assembly by a snap-fit connection, the external cladding assembly being constructed of a metal type material;</p>	<p>The VistaLuxe® Window Cross-Sections have an external cladding assembly <b>141</b> (shaded in green, above) including a plurality of cladding members <b>141a</b>, <b>141b</b>, <b>141c</b>, <b>141d</b> that form a frame (<b>141c</b> shown by way of example below). External cladding assembly <b>141</b> has inward projections <b>142</b> and <b>143</b> that are designed to engage recesses <b>114a</b> and <b>114</b> located on base frame members <b>111a</b>, <b>111b</b>, <b>111c</b>, <b>111d</b> (shaded red), by a snap-fit connection. External cladding assembly <b>141</b> is constructed of a metal type material (extruded aluminum):</p> 

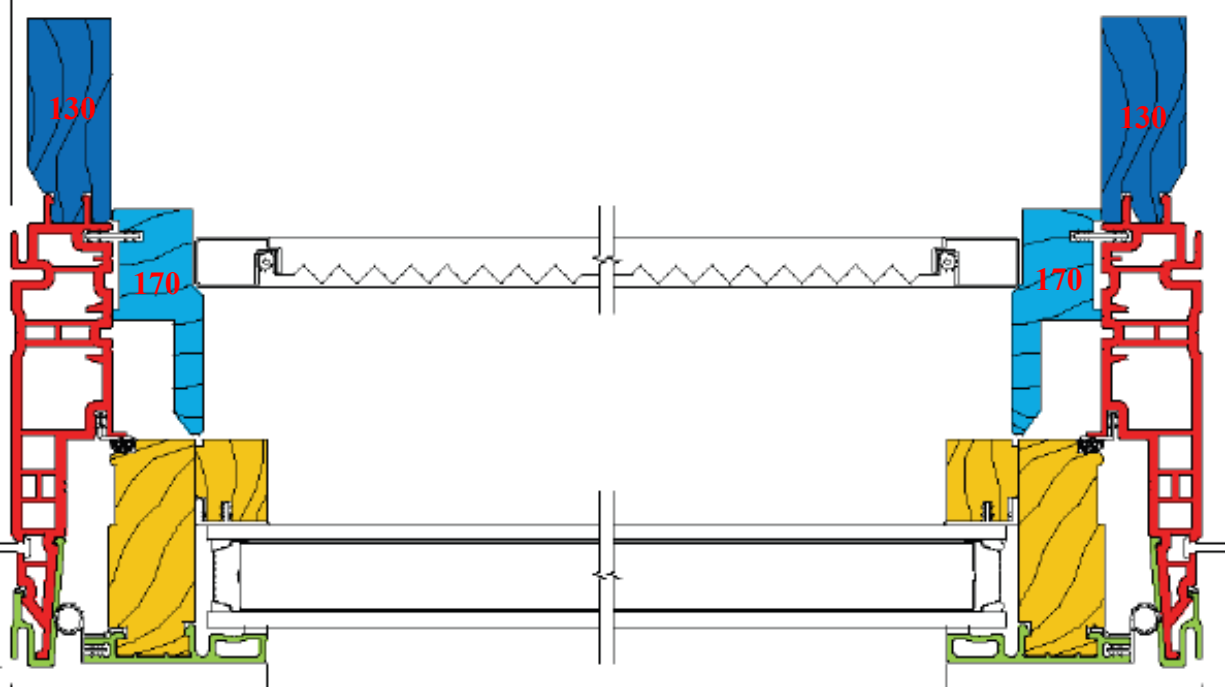
<b><u>'365 Patent Claim Element</u></b>	<b><u>VistaLuxe® Casement and Awning Products<sup>1,2</sup></u></b>
<p>1.c.1 an interior trim assembly including a jamb extender assembly, a head stop, a sill stop, and two side stops extending between the head and sill stops, the interior trim assembly concealing at least a portion of the base frame assembly from view from an interior side,</p>	<p>The VistaLuxe® Window Cross-Sections have an interior trim assembly (150, 160, 170) including a jamb extender assembly 130, a head stop 150, a sill stop 160, and two side stops 170 extending between the head 150 and sill 160 stops. The interior trim assembly (150, 160, 170) conceals at least a portion of the base frame assembly 110 (comprising 111a, 111b, 111c, and 111d, shaded in red) from view from an interior side.</p> 

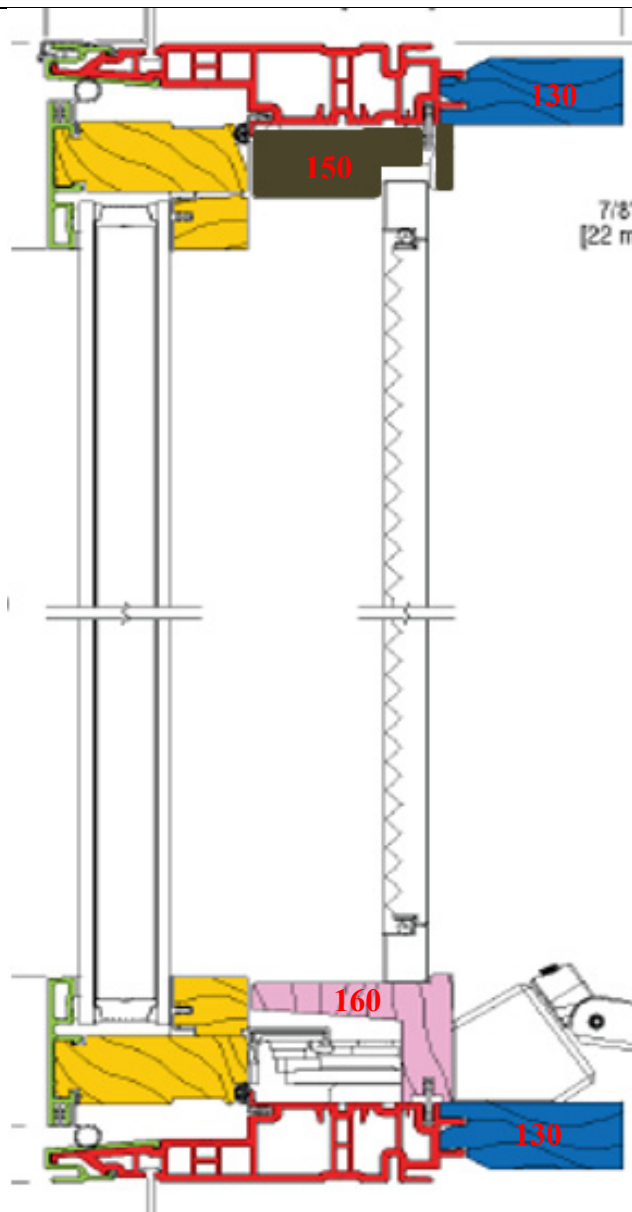

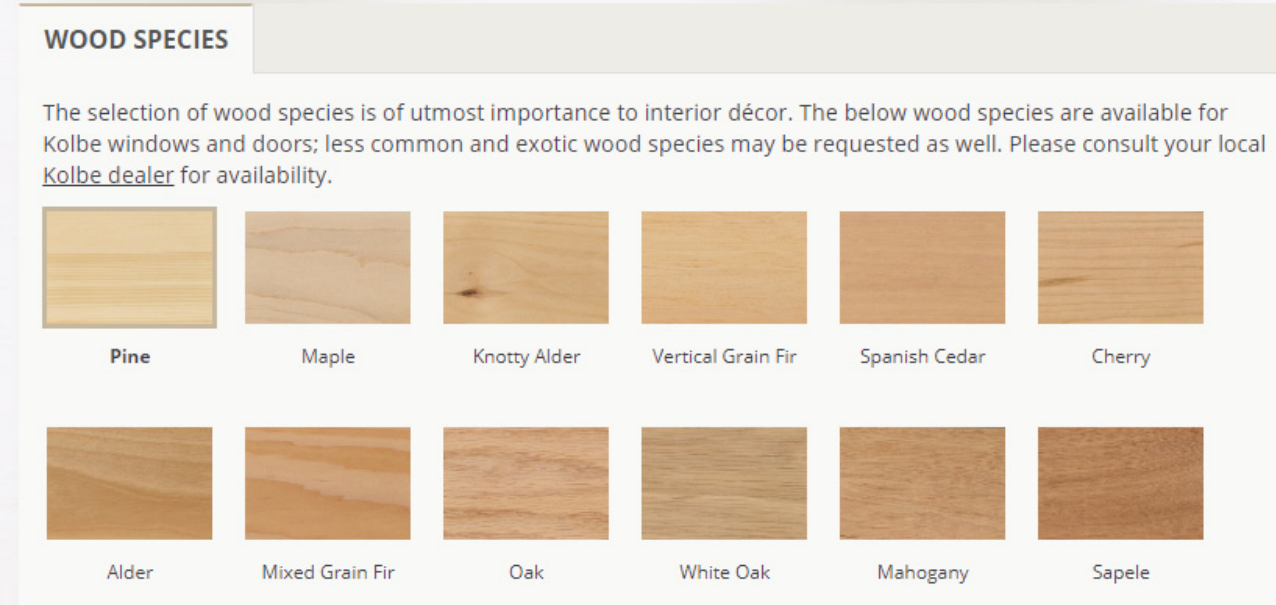
<b><u>'365 Patent Claim Element</u></b>	<b><u>VistaLuxe® Casement and Awning Products<sup>1,2</sup></u></b>
1.c.2 each component of the interior trim assembly being constructed of a wood type material and	<p>Each component of the interior trim assembly (<b>150, 160, 170</b>) are constructed of a wood type material. See <a href="https://www.kolbewindows.com/windows/vistaluxe-casement#Op124&amp;OpT675&amp;OpS2939">https://www.kolbewindows.com/windows/vistaluxe-casement#Op124&amp;OpT675&amp;OpS2939</a></p>  <p><b>WOOD SPECIES</b></p> <p>The selection of wood species is of utmost importance to interior décor. The below wood species are available for Kolbe windows and doors; less common and exotic wood species may be requested as well. Please consult your local <a href="#">Kolbe dealer</a> for availability.</p> <p>Pine Maple Knotty Alder Vertical Grain Fir Spanish Cedar Cherry</p> <p>Alder Mixed Grain Fir Oak White Oak Mahogany Sapele</p>
1.c.3 directly attached to the base frame assembly with a non-adhesive connection, wherein the jamb extender assembly is connected to the base frame assembly with the base frame member	<p>The VistaLuxe® Window Cross-Sections show that the interior trim assembly is directly attached to the base frame assembly <b>110</b> (comprising <b>111a</b>, <b>111b</b>, <b>111c</b>, and <b>111d</b>, shaded in red) with a non-adhesive connection (for example via attachment clips <b>152</b>, <b>162</b>, and <b>172</b>). The jamb extender assembly <b>130</b> is connected to the base frame assembly <b>110</b> with the base frame member extension clips <b>115</b> to form a snap-fit connection such that the extension clips <b>115</b> extend beyond an interior face of the head <b>150</b> and sill stops <b>160</b> and at least beneath the two side stops <b>170</b>. The inwardly</p>

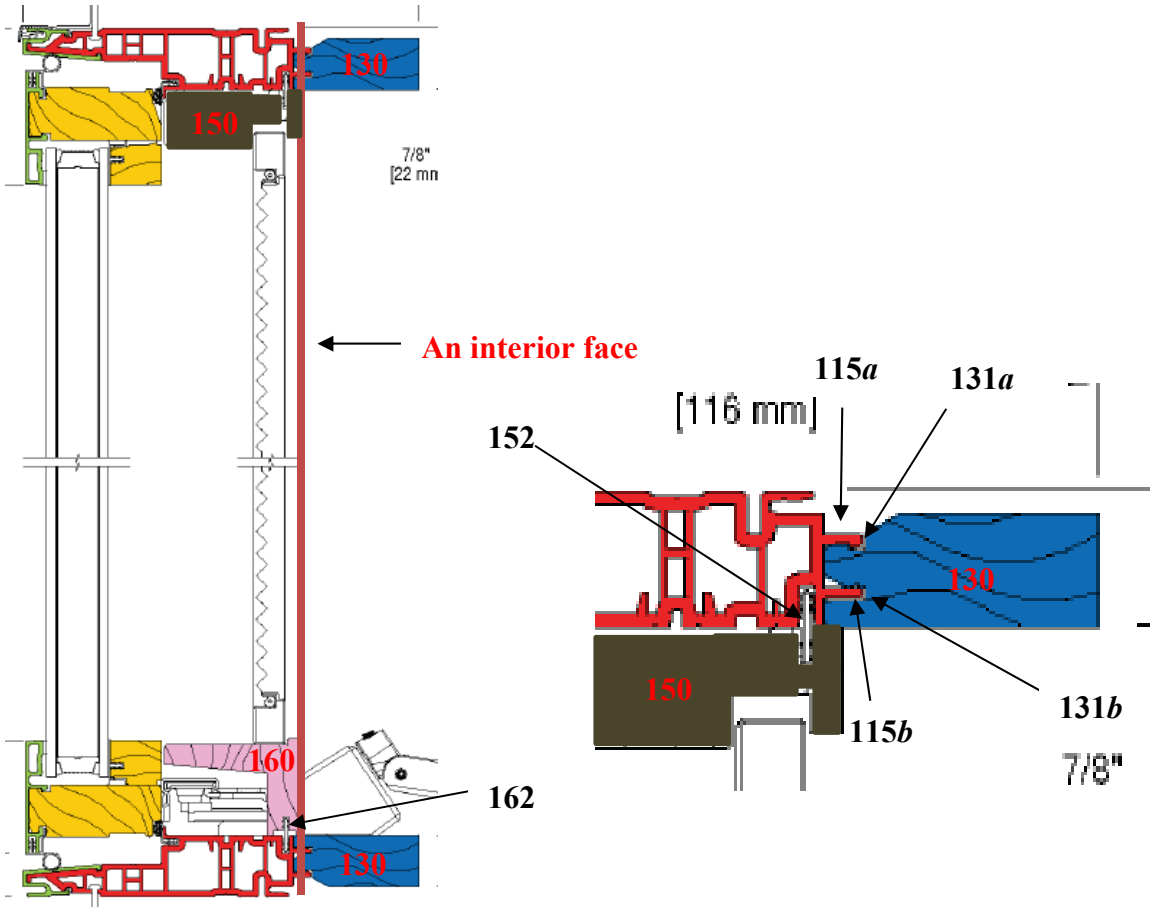
<p><b><u>'365 Patent Claim Element</u></b></p>	<p><b><u>VistaLuxe® Casement and Awning Products<sup>1,2</sup></u></b></p>
<p>extension clips to form a snap-fit connection such that the extension clips extend beyond an interior face of the head and sill stops and at least beneath the two side stops; and</p>	<p>extending protrusions <b>115a</b> and <b>115b</b> of each clip <b>115</b> engage the corresponding recesses <b>131a</b> and <b>131b</b> of jamb extender assembly <b>130</b>.</p> 

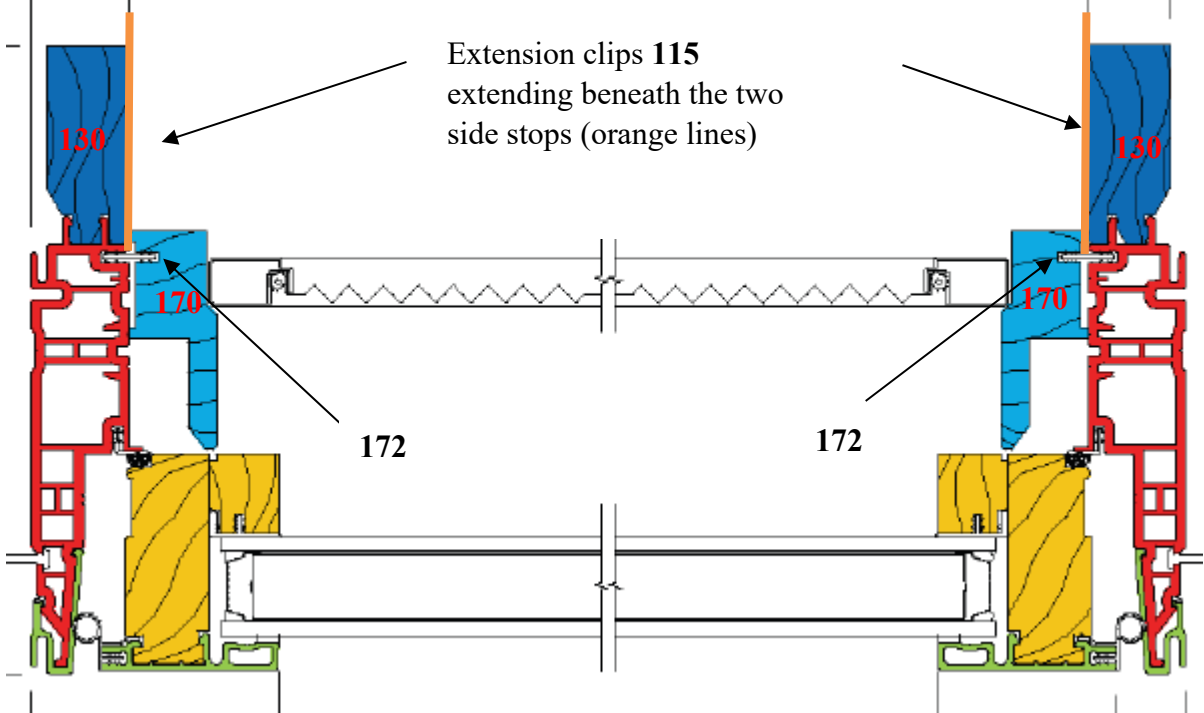
<p><b><u>'365 Patent Claim Element</u></b></p>	<p><b><u>VistaLuxe® Casement and Awning Products<sup>1,2</sup></u></b></p>
	
<p>1.d.1 a sash assembly constructed and arranged to hold a window pane, the sash assembly being operably connected to the</p>	<p>The VistaLuxe® Window Cross-Sections show a sash assembly <b>120</b> constructed and arranged to hold a window pane <b>121</b>. The sash assembly <b>120</b> is operably connected to the base frame assembly, and has an exterior sash assembly <b>125</b> constructed of a metal type material and an interior sash assembly <b>122</b> constructed of a wood type material.</p>

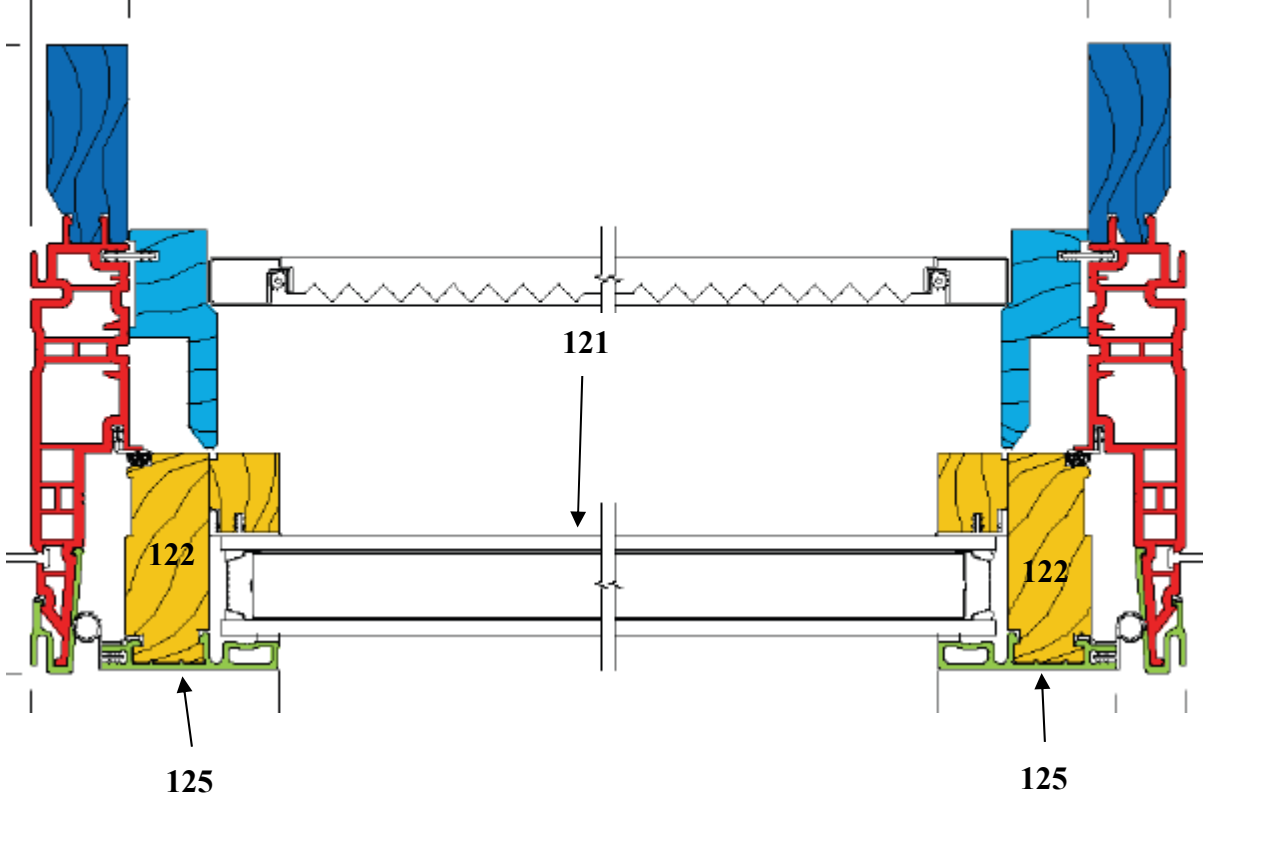

<p><b><u>'365 Patent Claim Element</u></b></p>	<p><b><u>VistaLuxe® Casement and Awning Products<sup>1,2</sup></u></b></p>
<p>base frame assembly and having an exterior sash assembly constructed of a metal type material and an interior sash assembly constructed of a wood type material,</p>	 <p>The diagram is a cross-sectional view of a window assembly. It features a central horizontal sash assembly (121) with a zigzag internal structure. This sash is flanked by two vertical sash assemblies (122) with a wood-grain texture. These are mounted on a base frame assembly (125) shown in red. The entire unit is set within a wall opening, with blue material representing the wall on either side. Arrows point from the labels 121, 122, and 125 to their respective components.</p>

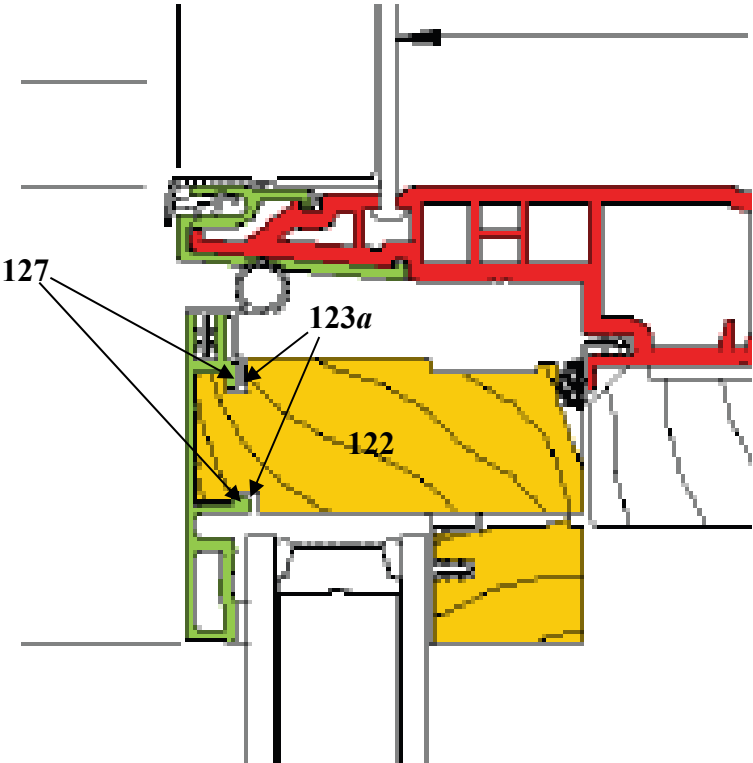
<p><b><u>'365 Patent Claim Element</u></b></p>	<p><b><u>VistaLuxe® Casement and Awning Products<sup>1,2</sup></u></b></p>
<p>1.d.2 the interior sash assembly being directly connected to the exterior sash assembly to form a wood-metal snap-fit connection;</p>	<p>The VistaLuxe® Window Cross-Sections have an interior sash assembly <b>122</b> directly connected to the exterior sash assembly <b>125</b> to form a wood-metal snap-fit connection (via attachment clips <b>127</b> that engages recesses <b>123a</b> of interior sash assembly <b>122</b>).</p> 

<b><u>'365 Patent Claim Element</u></b>	<b><u>VistaLuxe® Casement and Awning Products<sup>1,2</sup></u></b>
(e) wherein the base frame members and the cladding members are each formed from a stock material having a uniform profile.	As can be seen from the Figures and explanation above, the base frame members (extruded vinyl) and the cladding members (extruded aluminum) for the VistaLuxe® Products are formed from stock materials and have a uniform profile.

# Appendix A

## EX 2028

VISTALUXE COLLECTION - FLUSH STYLE  
CRANK-OUT CASEMENT/AWNING - FLUSH STYLE - OPERATING  
4-9/16" JAMB - SCREEN  
DOUBLE PANE GLASS  
HORIZONTAL CROSS SECTION

